

8 7 6 5 4 3 2 1

REVISIONS			
REV.	DESCRIPTION	DATE	APPROVED
A	REDRAWN IN SW	8/8/2006	

D

D

C

C

B

B

A

A

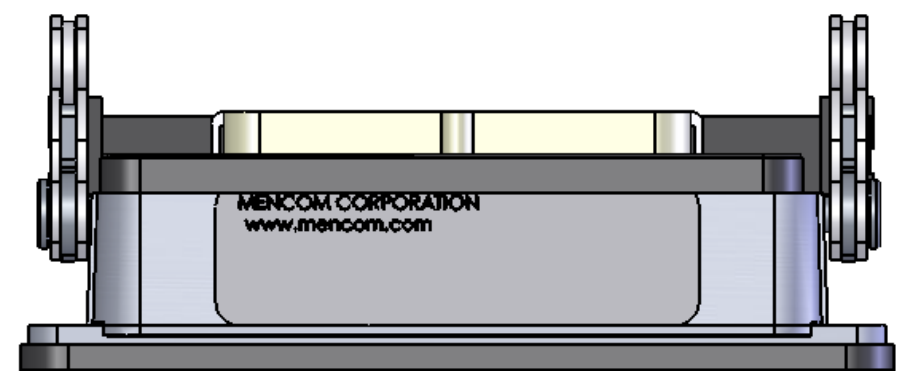
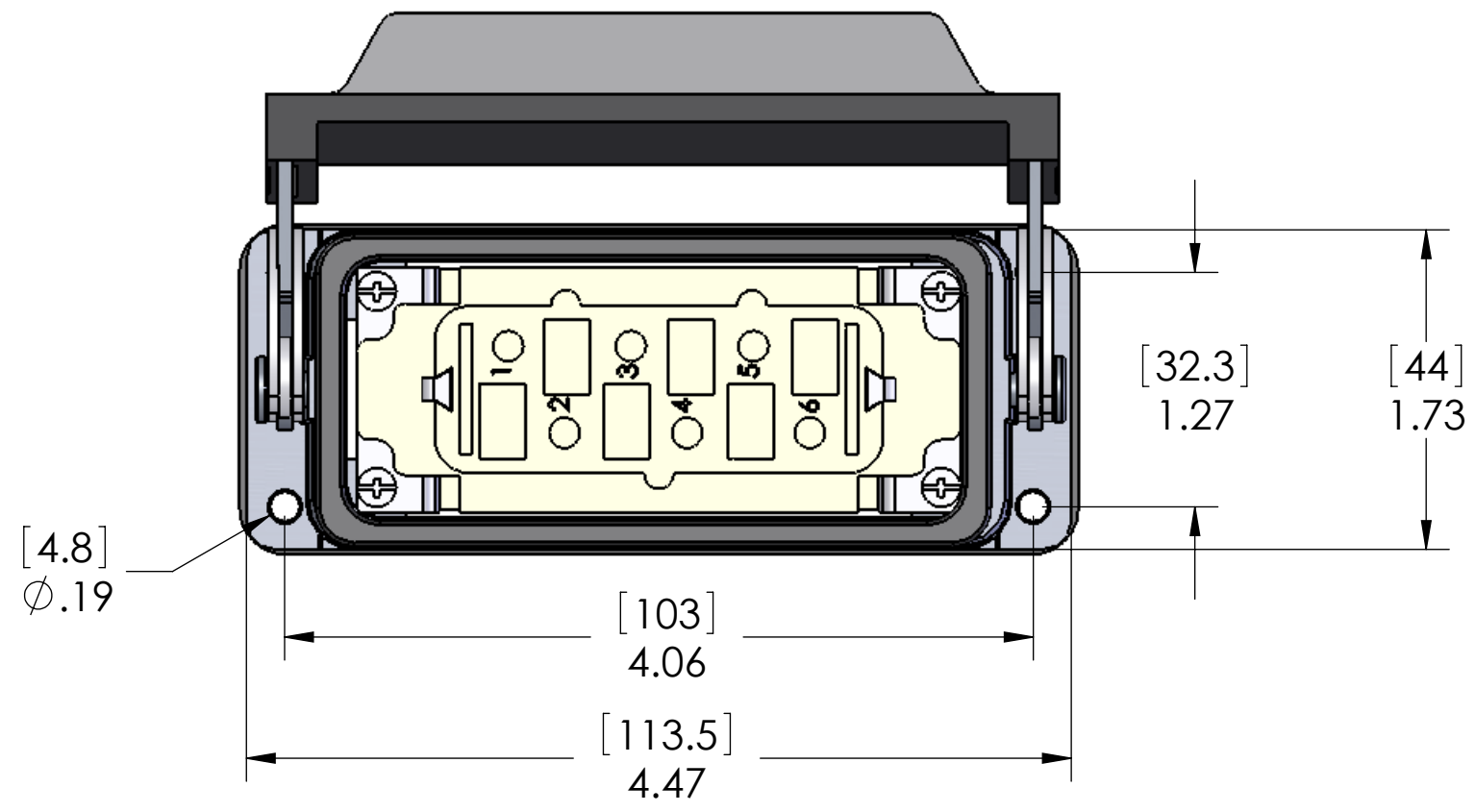

CONNECTIONS MADE VIA SCREW TERMINALS

MATERIALS:	
BODY:	EPOXY COATED CAST ALUMINUM
HANDLE:	STAINLESS STEEL WITH POLYAMIDE
INSERT:	THERMOPLASTIC RESIN, UL 94V-0
CONTACTS:	SILVER PLATED COPPER ALLOY
GASKET:	NBR

PROPRIETARY AND CONFIDENTIAL
 THE INFORMATION CONTAINED IN THIS DRAWING IS THE SOLE PROPERTY OF MENCOM CORPORATION. ANY REPRODUCTION IN PART OR AS A WHOLE WITHOUT THE WRITTEN PERMISSION OF MENCOM CORPORATION IS PROHIBITED.

UNLESS OTHERWISE SPECIFIED:		NAME	
DIMENSIONS ARE IN INCHES AND [MM]		DRAWN	DWM
		CHECKED	
		ENG APPR.	
		MFG APPR.	
		Q.A.	
		COMMENTS:	
MATERIAL			
FINISH			
DO NOT SCALE DRAWING			

MENCOM CORPORATION		
TITLE:		
SIZE	DWG. NO.	REV
B	Z23-HP-FS	A
SCALE: 1:1	WEIGHT:	SHEET 1 OF 1

8 7 6 5 4 3 2 1