

the modular inserts must be installed in suitable frames which in turn are installed in traditional housings or COB panel support

frames for modular units ..... page: 151

- characteristics according to EN 61984: **40A 400/690V 6kV 3**
- UL, CSA, CCC, GL certified
- for maximum current load, see the insert load curve section on page 34
- for contact crimping instructions, please see the crimping tool section (40A contacts, CXF and CXM series) on pages 298, 300

modular units, crimp connections



40A crimp contacts silver plated

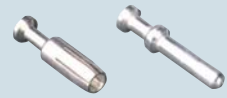

description	part No.	part No.
without contacts (to be ordered separately) - female inserts for female contacts - male inserts for female contacts	<b>CX 03 4F</b> <b>CX 03 4M</b>	
40A female crimp contacts 1.5 mm <sup>2</sup> AWG 16 2.5 mm <sup>2</sup> AWG 14 4 mm <sup>2</sup> AWG 12 6 mm <sup>2</sup> AWG 10  40A male crimp contacts 1.5 mm <sup>2</sup> AWG 16 2.5 mm <sup>2</sup> AWG 14 4 mm <sup>2</sup> AWG 12 6 mm <sup>2</sup> AWG 10		<b>CXFA 1.5</b> <b>CXFA 2.5</b> <b>CXFA 4.0</b> <b>CXFA 6.0</b>  <b>CXMA 1.5</b> <b>CXMA 2.5</b> <b>CXMA 4.0</b> <b>CXMA 6.0</b>  <b>silver plated</b>

dimensions in mm

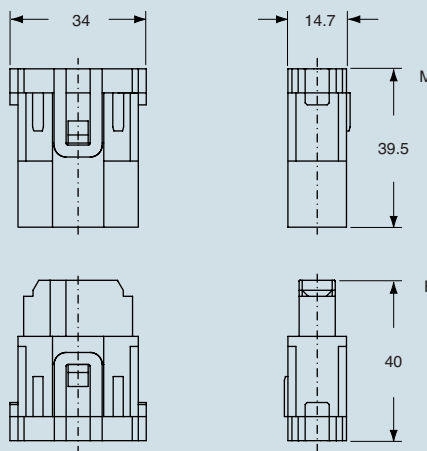

contacts side (front view)

side with reference arrow ▲

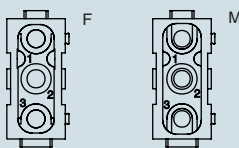

- footprint 1 module

dimensions in mm

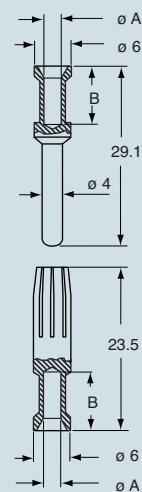

**CXF and CXM contacts**

conductor section mm <sup>2</sup>	conductor slot	
	$\sigma A$ (mm)	B (mm)
1.5	1.8	9
2.5	2.2	9
4	2.85	9.6
6	3.5	9.6

- stripping length see section feature of inserts on page 13

dimensions shown are not binding and may be changed without notice